

BY KATHLEEN BROWN



1. High-Performance Windows and Doors

Revolution XL by Deceuninck is a line of high-performance windows and doors that maximize sunlight while minimizing bulk. Revolution XL Tilt & Turn Windows have a multifunctional sash that tilts, swings, and locks with one hand, the company says, while doors are available in three models: tilt and slide, terrace, and lift and slide. Engineered for thermal performance (R-7 and above), sound mitigation, and durability, Revolution XL windows and doors have interior, exterior, and internal seals to prevent air and water infiltration. Pricing varies according to configuration, color, and finish. deceuninckna.com



2. A Matte Countertop Finish

Cambria recently introduced Cambria Matte, a low-sheen alternative to the company's standard high-gloss quartz-countertop finishes, which resemble natural stone slabs. According to the company, the new matte finish is low-maintenance—requiring no sealing or polishing—and is scratch- and chip-resistant, nonporous, and nonabsorbent. Cambria Matte finish is available for all 140 of Cambria's designs. Cambria quartz countertops are priced around \$85 per square foot, on average. cambriausa.com



3. Instant, Filtered Hot Water Faucets

InSinkErator's new Iris (shown) and Melea instant-hot-water dispensers offer users on-demand access to near-boiling, filtered water. The faucets are compatible with InSinkErator's hot-water tank and filtration system, which is designed to remove impurities. Other features include single-hole installation and a 360-degree swivel spout. Faucet prices range from \$300 to \$560, depending on finish. insinkerator.com

4. A Low-Profile Solar System

The GAF DecoTech Roof-Integrated Solar System is a low-profile alternative to standard rack-mounted solar panels. A black gloss finish and hidden wiring help blend panels into the roof. Counterflashing and step flashing form a protective shield against leaks, debris, and animal infestation. The DecoTech Roof-Integrated Solar System is sold nationwide through GAF-certified contractors, so pricing varies. gaf.com

5. Sliding-Barn-Door Hardware

DesignGlide Barn Door Hardware by Jeld-Wen can be installed in any standard-sized interior door frame in just a few steps to convert a standard door into a barn door—with no reframing or custom doors required. DesignGlide features a soft close and includes accent rails that attach to the top and bottom of a standard interior door. Prices start at \$200 and vary by location. jeld-wen.com

6. Noncombustible Insulation

The JM CladStone Water & Fire Block Insulation from Johns Manville is a noncombustible mineral-wool product that offers continuous insulation and moisture management for cavity wall and rain-screen applications. According to the company, JM CladStone facilitates water drainage while providing thermal efficiency, fire resistance, and acoustical performance. The basalt-based insulation also repels moisture and is mildew- and corrosion-proof, says the company. It can be installed with a variety of exterior claddings and fasteners. Pricing is determined on a per-project basis. jm.com

7. An Eco-Friendly Flooring Underlayment

DriTac's new Impact and Double Impact flooring underlayments promote indoor air quality by protecting from subfloor emissions. Hypoallergenic and nontoxic, the underlayment resists mold, mildew, and bacteria growth and is designed for resilient flooring, wood, and laminate. DriTac says its "Safeguard Seaming System" creates a vapor barrier between two pieces of underlayment, while its "Total Sound Reduction System" provides strong footfall performance. Prices range from \$0.50 to \$0.75 per square foot. dritac.com

8. Predrilled Stair Posts

Feeney's new predrilled stair posts and pickets allow for faster installation by eliminating the need to drill holes in the field. Slotted holes minimize the size of openings while allowing for angle flexibility. The posts are compatible with all Feeney Design-Rail Aluminum Railing systems that use 1/8-inch CableRail infill. Extra material on the top and bottom of the posts facilitates trimming once post locations are determined. Three angle ranges and railing heights are offered, with custom options available. Prices range from \$70 to \$115. feeneyinc.com

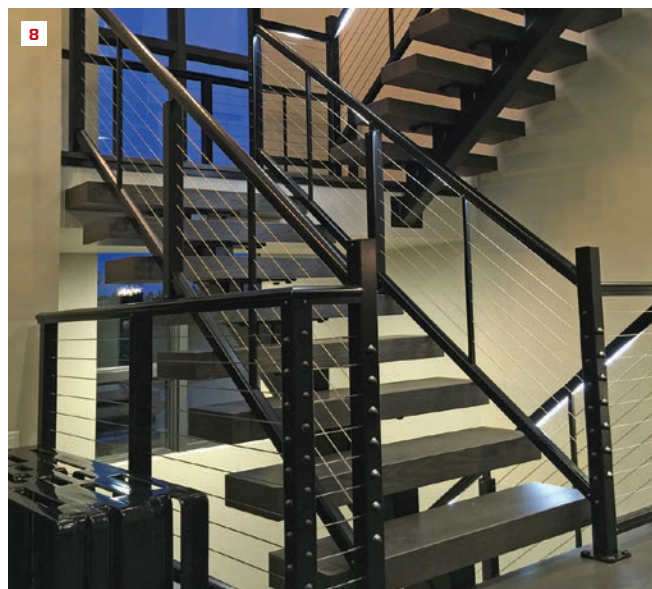
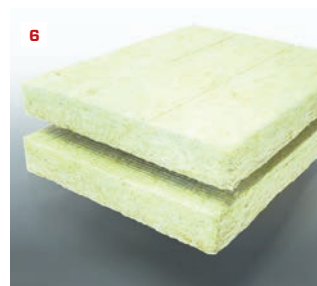

Products

9. A Wi-Fi Connected Thermostat

Bosch Thermotechnology's new programmable Connected Control Thermostat allows homeowners to monitor and control temperature settings remotely from a smartphone app. The full-color, 5-inch, touchscreen thermostat is compatible with most HVAC systems, the company says. Homeowners can create temperature presets and schedules, access local weather data, and set a "vacation mode" to automatically control heating and cooling functions while away. The Connected Control Thermostat is available for \$170. bosch-climate.us

9



10. A Clean Trim Finish

The QuickTrim System by Trim Solutions is an exterior PVC trim with a hidden-fastening system, allowing for a clean finish and fast installation—with no face-nailing, caulking, or painting necessary. The PVC flat board stock is fitted standard with a nailing flange and starter strip and can be used for corners, sub rakes, mantels, frieze boards, casings, and sills. An optional J-channel is available for added protection from water. A 5/4x4 board costs between \$4 and \$4.50 per lineal foot. trimolutions.net

10



11. A Nonadhesive Floor Runner

Pro Tect says its Runner Floor Protection works like a gym sneaker, with soft rubber backing that keeps it in place when pressure is applied. Made from Eco-Fi, a polyester fiber derived from recycled plastic bottles, Runner Floor Protection offers heavy-duty impact protection for floors and countertops in high-traffic areas. The non-porous floor runner can be used with hardwood floors, tile, marble, and linoleum. Rolls come in 24-, 36-, or 48-inch widths, with 50-, 100-, and 150-foot length options. Prices range from \$63 to \$360, depending on size selection. pro-TECT.com

11



12. A Dual-Purpose Corner Seal

Georgia-Pacific's newest addition to its ForceField line is a corner seal, for both inside and outside corners, that bends along a center channel. The semi-rigid polypropylene strip is 4 inches wide and 0.03 inch thick, providing coverage for an area that is notoriously difficult to seal, GP says. ForceField Corner Seal is designed for use with ForceField sheathing panels and can be installed directly onto those panels to form an air and water barrier. The corner seal is sold in 200-foot rolls and is available nationwide through building materials dealers. buildgp.com/gp-forcefield

12

